

Disassembly instruction



CONTENT

	Seite
1. Stator disassembly	3
1.1 Storage/Changing	3
2. Motor assembly	4
3. Rotor assembly	4
4. Seal kit /Bearing kit	5
5. Seal kit	5

TOOLS

Hook Key (ø30) T1
(not included)



Allen Key (M3) T2
(not included)



Mounting Aid T3
(included)



1. STATOR DISASSEMBLY

Unscrew Luer-connector (1) from the pump housing (2) with Hook Key (T1).



1.1 STORAGE/CHANGING

Unscrew stator (3) carefully (CCW) from the pump housing (2). After the stator has been unscrewed from the thread of the housing, fix the coupling with the Mounting Aid (T3) and remove the stator carefully from the rotor.

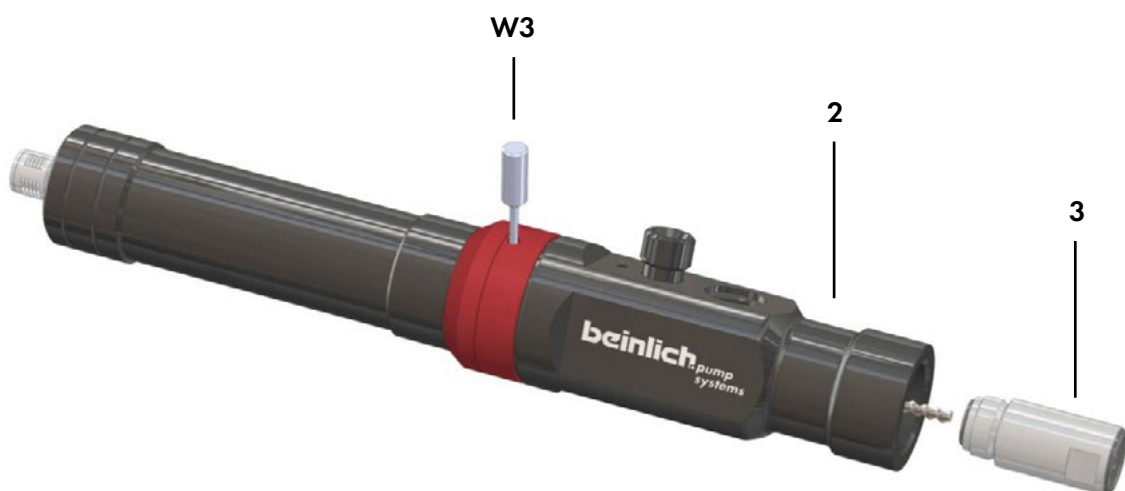

In case of longer downtimes (e.g. storage), the stator must be disassembled from the rotor, to avoid deformation.

2. MOTOR ASSEMBLY

To disassemble the motor assembly, loosen grub screw (4), with Allen Key (T2), in the mounting flange (6) and remove motor assembly (5).

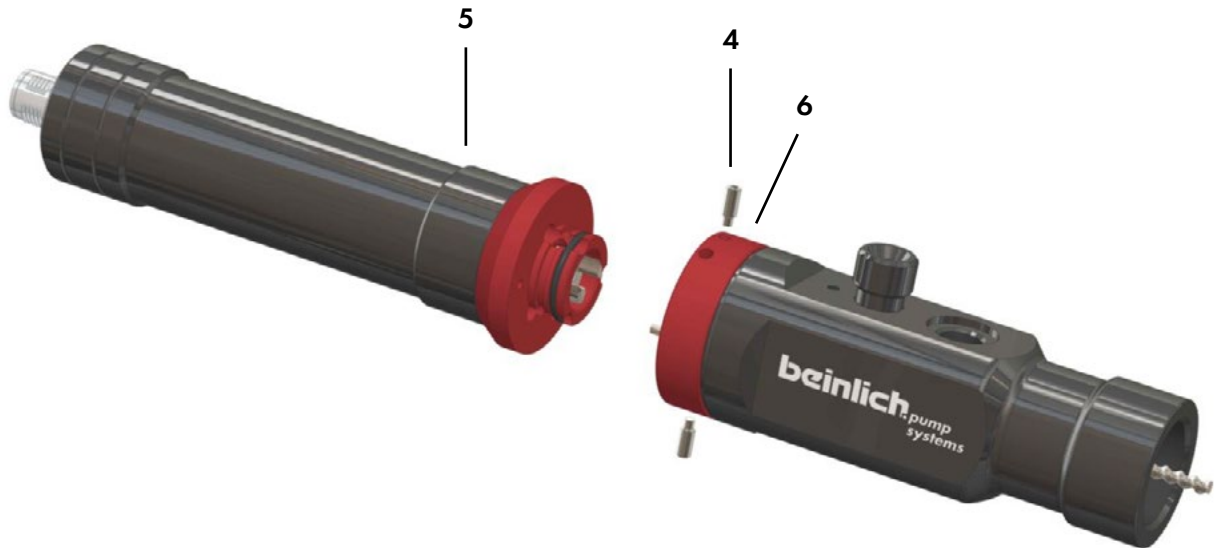

3. ROTOR ASSEMBLY

Unscrew mounting flange (6) and remove the seal and bearing kit (7) with the rotor assembly (8) from the pump housing (2).

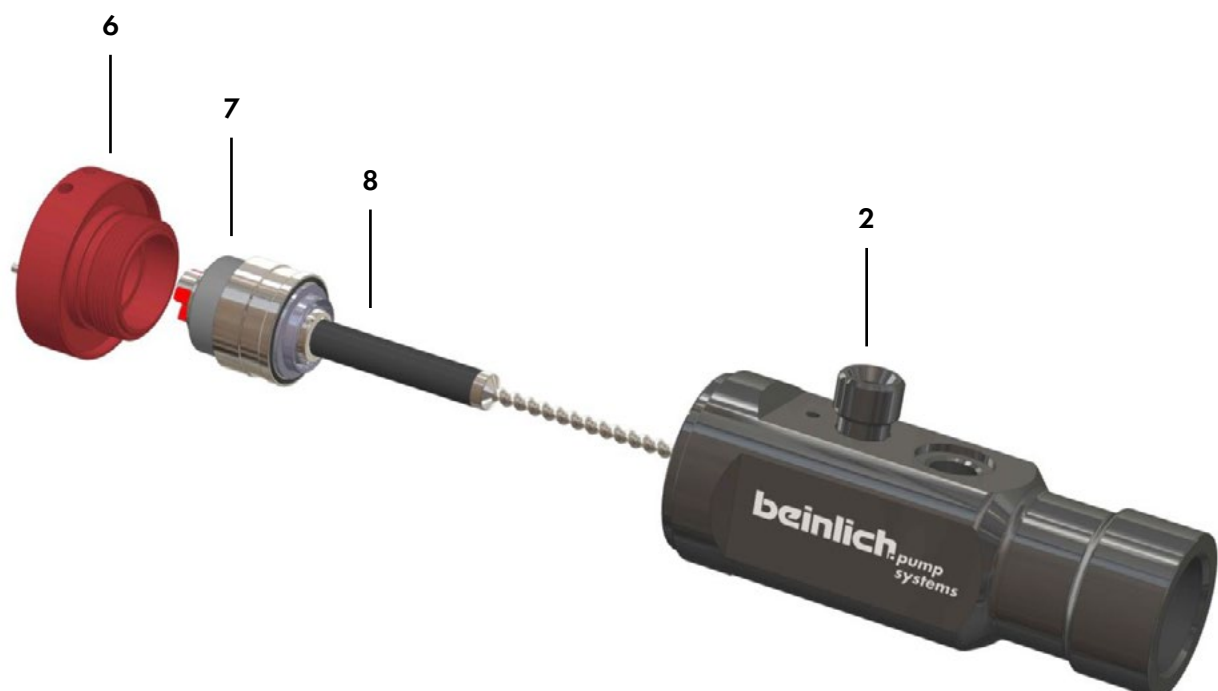

4. SEAL KIT/BEARING KIT

Pull the sealing package (10) carefully from the rotor assembly (9).

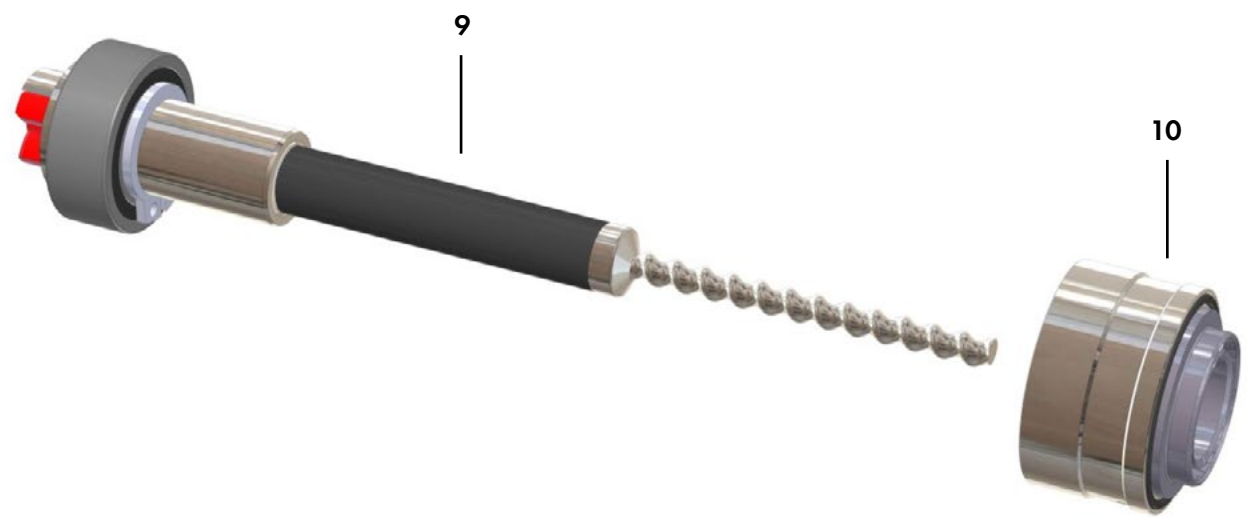

5. SEAL KIT

- Sealing seat (11)
- Seal support (12)
- Radial shaft seal (13)
- O-Ring (14)



beinlich.*pump*
systems

Beinlich Pumpen GmbH
Gewerbestraße 29
58285 Gevelsberg/Germany
Phone +49 (0) 23 32 / 55 86 0
info@beinlich-pumps.com
www.beinlich-pumps.com



A company of
e.holding
FLUID TECHNOLOGY GROUP